

CENTRAL ACCESS SCHEME FOR THE CITY OF KILKENNY  
COMPULSORY PURCHASE ORDER (No.1) OF 2011

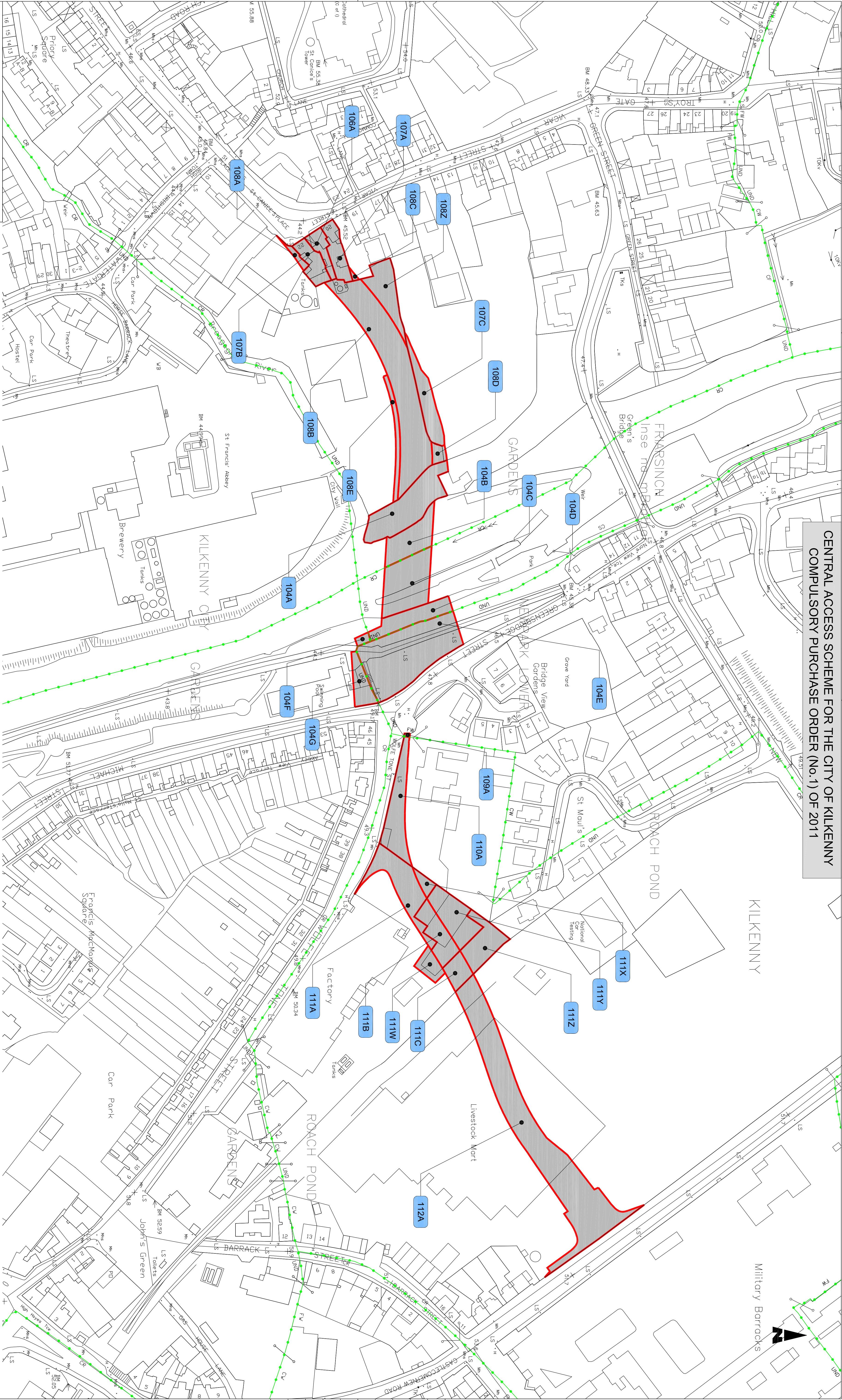

The Official Seal of Kilkenny County Council was affixed hereto in the presence of :

County Manager:  
Nominated Member:  
County Secretary:  
Dated This Day of

Ordnance Survey Ireland data reproduced under OSI Licence Number 2003/07/COMA Kilkenny County Council. An authorised reproduction infringes Ordnance Survey Ireland Copyright. © Ordnance Survey Ireland 2003.

Client



Project Title  
CENTRAL ACCESS SCHEME  
FOR THE CITY OF KILKENNY  
Compulsory Purchase Order (No. 1) of 2011

Drawing Title

CPO DEPOSIT MAPS  
Sheet 1 of 1

Drawing Number			
R0505/CPO/101			
Scale at A1			
1:1,000			
Designed	Checked	Date	
A. Lannon	R. Spencer	January '11	
Drawn	Approved	Drawing Status	
A. Lannon	M. L. Roux	CPO	